

## REVISIONS

- | REV. | DESCRIPTION                       | DATE     | APPROVED     |
|------|-----------------------------------|----------|--------------|
| A    | INITIAL RELEASE FOR MANUFACTURING | MAR2019  | R.DAVIS      |
| B    | UPDATED DRAWING TO CURRENT FORMAT | 8/3/2020 | K.dRUMHILLER |

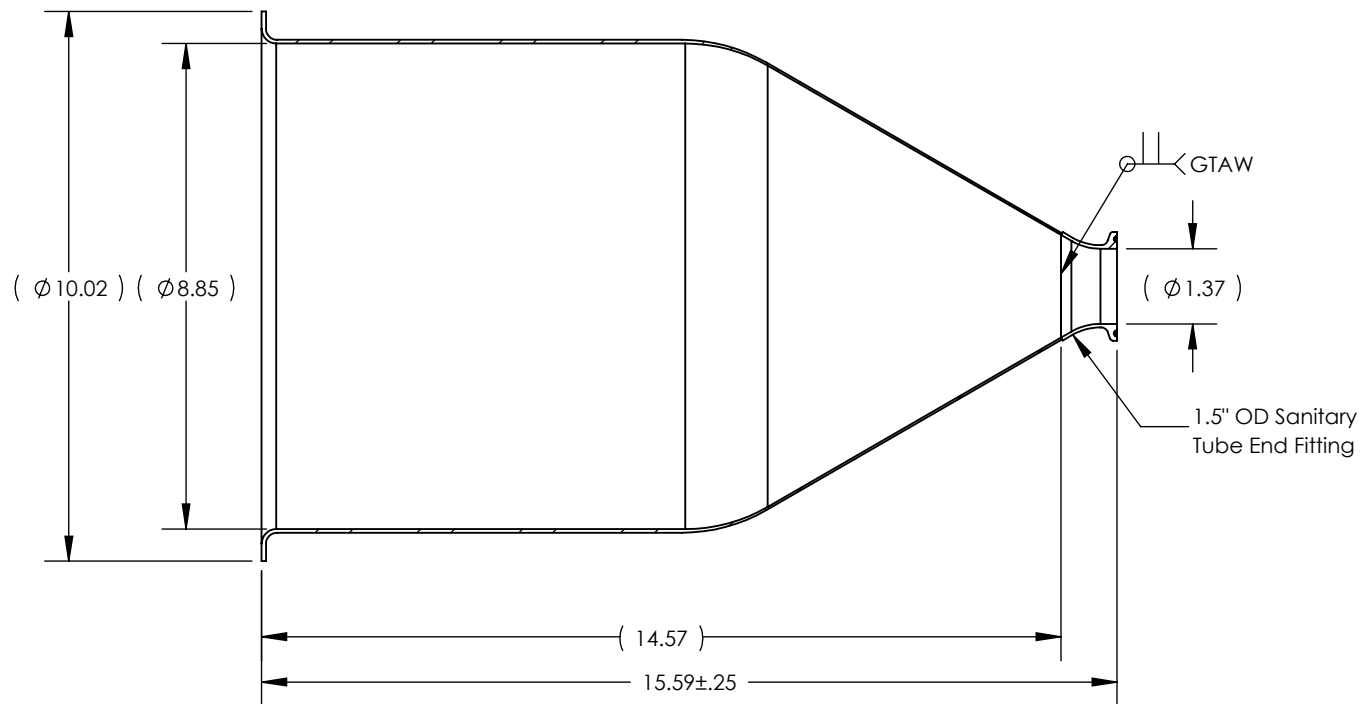

SECTION A-A

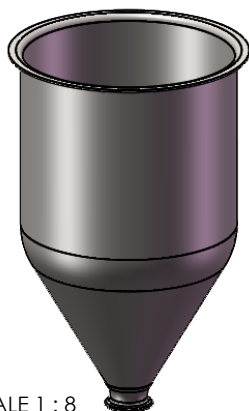

SCALE 1 : 8

UNLESS OTHERWISE SPECIFIED:

1. DO NOT SCALE DRAWING
2. DIMENSIONS ARE IN INCHES
3. TOLERANCE:  
FRACTIONAL  $\pm .25$   
X.X  $\pm .1$   
X.XX  $\pm .03$   
X.XXX  $\pm .010$   
ANGULAR:  $\pm 2$  DEG.
4. INTERPRET DRAWING PER  
ASME-Y14.5M-1994 STANDARDS
5. THIRD ANGLE PROJECTION
6. REMOVE BURRS & BREAK ALL  
SHARP EDGES WITH R0.03  $\pm 0.02$

	NAME	DATE
DRAWN	R.DAVIS	MAR2019

**PROPRIETARY AND CONFIDENTIAL**  
THE INFORMATION CONTAINED WITHIN THIS  
DRAWING IS THE SOLE PROPERTY OF  
TOLEDO METAL SPINNING COMPANY. ANY  
REPRODUCTION IN PART OR AS A WHOLE  
WITHOUT WRITTEN PERMISSION OF TOLEDO  
METAL SPINNING COMPANY IS PROHIBITED

TITLE:

HOPPER WITH WELDED 1.5" TUBE FITTING

SIZE <b>A</b>	DRAWING NUMBER <b>104003</b>		REV <b>B</b>
SCALE: 1:3.5		WEIGHT: 6.36	SHEET 1 OF 1